

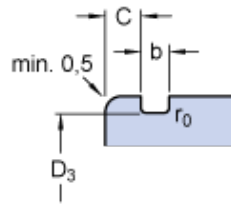

BEARING-SINGAPORE (PTE)LTD.

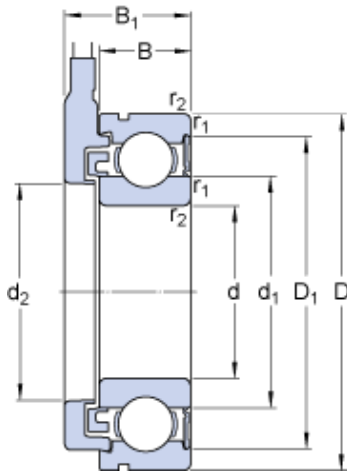

30 mm x 62 mm x 16 mm SKF
BMD-6206/064S2/UA008A deep groove ball bearings

Bearing No. BMD-6206/064S2/UA008A

BMD-6206/064S2/UA008A Bearing 2D drawings and 3D CAD models

Size	62x30x22.2 mm
Bore Diameter	62 mm
Outer Diameter	30 mm
Width	22,2 mm
d	30 mm
D	62 mm
B ₁	22.2 mm
B	16 mm
d ₁	40.36 mm
d ₂	37.4 mm
D ₁	54.1 mm
D ₂	58.1 mm
D ₃	59.61 mm
C	3.28 mm
b	1.9 mm
r ₀	0.6 mm
r _{1,2} - min.	1 mm
L	540 mm
Tolerance cable length L - ±	10 mm
d _a - min.	35 mm
d _b - min.	35 mm
d _b - max.	40 mm
D _a - max.	57 mm



BEARING-SINGAPORE (PTE)LTD.

r_a - max.	1 mm
Cable connector type	Free cable end
Number of pulses per revolution - N	64
Period accuracy	$\pm 4\%$
Phase shift output signal	90 °
Tolerance phase shift output signal	$\pm 30\text{ °}$
Basic dynamic load rating - C	19.5 kN
Basic static load rating - C_0	11.2 kN
Fatigue load limit - P_u	0.475 kN
Limiting speed	7500 r/min
Calculation factor - k_r	0.025
Calculation factor - f_0	14
Mass sensor unit	0.225 kg
Category	Ball Bearings
Inventory	0.0
Manufacturer Name	SKF
Minimum Buy Quantity	N/A
EAN	7316576085727
Weight / US pound	0.01
Product Group	B00308
B_1	22.2 mm
d_1	40.36 mm
d_2	37.4 mm
D_1	54.1 mm
D_2	58.1 mm
D_3	59.61 mm
r_0	0.6 mm
$r_{1,2}$ min.	1 mm
\pm	10 mm
	35 mm



BEARING-SINGAPORE (PTE)LTD.

d^a min.

--	--



BEARING-SINGAPORE (PTE)LTD.

d_b min.	35 mm
d_b max.	40 mm
D_a max.	57 mm
r_a max.	1 mm
Number of pulses per revolution N	64
Period accuracy \pm	4 %
Phase shift output signal tolerance \pm	30 °
Basic dynamic load rating C	19.5 kN
Basic static load rating C_0	11.2 kN
Fatigue load limit P_u	0.475 kN
Calculation factor k_r	0.025
Calculation factor f_0	14
Snap ring	SP 62