

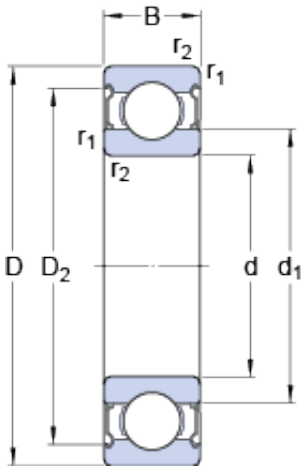

## BEARING-SINGAPORE (PTE)LTD.



17 mm x 26 mm x 5 mm SKF 61803-2Z deep groove ball bearings

Bearing No. 61803-2Z

61803-2Z Bearing 2D drawings and 3D CAD models

Size	26x17x5 mm
Bore Diameter	26 mm
Outer Diameter	17 mm
Width	5 mm
d	17 mm
D	26 mm
B	5 mm
d <sub>1</sub>	19.8 mm
D <sub>2</sub>	24.15 mm
r <sub>1,2</sub> - min.	0.3 mm
d <sub>a</sub> - min.	19 mm
d <sub>a</sub> - max.	19.6 mm
D <sub>a</sub> - max.	24 mm
r <sub>a</sub> - max.	0.3 mm
Basic dynamic load rating - C	2 kN
Basic static load rating - C <sub>0</sub>	1.3 kN
Fatigue load limit - P <sub>u</sub>	0.054 kN
Reference speed	56000 r/min
Limiting speed	28000 r/min
Calculation factor - k <sub>r</sub>	0.015
Calculation factor - f <sub>0</sub>	14.1
Category	Single Row Ball Bearings
Inventory	0.0
Manufacturer Name	SKF



## BEARING-SINGAPORE (PTE)LTD.

Minimum Buy Quantity	N/A
Weight / Kilogram	0.01
EAN	7316577611543
Product Group	B00308
Enclosure	2 Metal Shields
Precision Class	ABEC 1   ISO P0
Maximum Capacity / Filling Slot	No
Rolling Element	Ball Bearing
Snap Ring	No
Internal Special Features	No
Cage Material	Steel
Internal Clearance	C0-Medium
Inch - Metric	Metric
Long Description	17MM Bore; 26MM Outside Diameter; 5MM Outer Race Diameter; 2 Metal Shields; Ball Bearing; ABEC 1   ISO P0; No Filling Slot; No Snap Ring; No Internal Special Features
Category	Single Row Ball Bearing
UNSPSC	31171504
Harmonized Tariff Code	8482.10.50.68
Noun	Bearing
Keyword String	Ball
Manufacturer URL	<a href="http://www.skf.com">http://www.skf.com</a>
Manufacturer Item Number	61803 2Z
Weight / LBS	0.02
Outside Diameter	1.024 Inch   26 Millimeter
Outer Race Width	0.197 Inch   5 Millimeter
Bore	0.669 Inch   17 Millimeter
bore diameter:	17 mm
static load capacity:	1.27 kN



## BEARING-SINGAPORE (PTE)LTD.

outside diameter:	26 mm
precision rating:	Not Rated
overall width:	5 mm
finish/coating:	Uncoated
bore type:	Round
cage material:	Steel
closure type:	Double Shielded
outer ring width:	5 mm
row type & fill slot:	Single Row Non-Fill Slot
fillet radius:	0.3 mm
internal clearance:	C0
maximum rpm:	28000 RPM
dynamic load capacity:	2.03 kN
series:	61
$d_1$	19.8 mm
$D_2$	0 mm
$r_{1,2}$ min.	0.3 mm
$d_a$ min.	19 mm
$d_a$ max.	19.6 mm
$D_a$ max.	24 mm
$r_a$ max.	0.3 mm
Basic dynamic load rating C	2.03 kN
Basic static load rating $C_0$	1.27 kN
Fatigue load limit $P_u$	0.054 kN
Calculation factor $k_r$	0.015
Calculation factor $f_0$	14.1
Mass bearing	0.0082 kg