

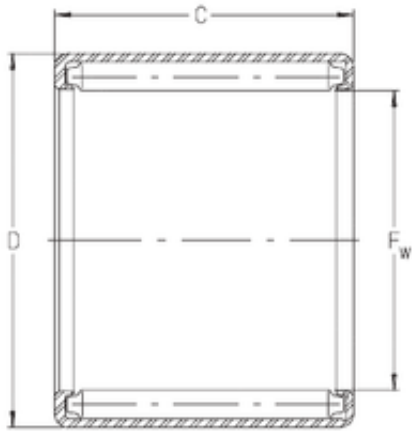

BEARING-SINGAPORE (PTE)LTD.

INA S3016 needle roller bearings

Bearing No. S3016



S3016 Bearing 2D drawings and 3D CAD models

Size	47.625x57.15x25.4 mm
Bore Diameter	47,625 mm
Outer Diameter	57,15 mm
Width	25,4 mm
Fw	47,625 mm
D	57,15 mm
C	25,4 mm
Weight	0,116 Kg
Basic dynamic load rating (C)	60 kN
Basic static load rating (C0)	126 kN