

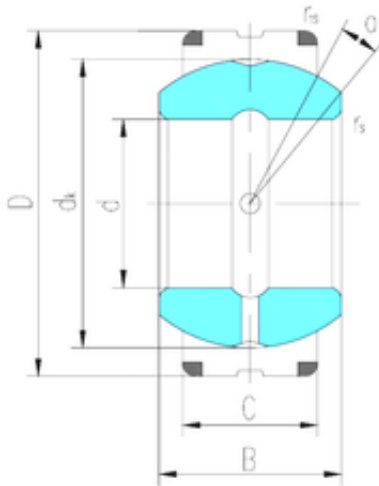

BEARING-SINGAPORE (PTE)LTD.



380 mm x 520 mm x 190 mm LS
GEC380XS-2RS plain bearings

Bearing No. GEC380XS-2RS

Size	380x520x190 mm
Bore Diameter	380 mm
Outer Diameter	520 mm
Width	190 mm
d	380 mm
D	520 mm
B	190 mm
C	160 mm
dk	450 mm
r min.	1,5 mm
r1 min.	4 mm
Angle	4 °
Weight	129 Kg
Basic dynamic load rating (C)	6300 kN

GEC380XS-2RS Bearing 2D drawings and 3D CAD models