

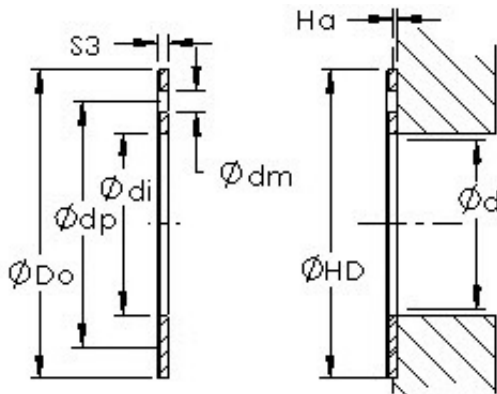

BEARING-SINGAPORE (PTE)LTD.



AST AST11 WC18 plain bearings

Bearing No. AST11 WC18

Bore Diameter	16 mm
Outer Diameter	32 mm
Bearing Type	thrust washer
Shaft Dia., Nominal (d)	16.0000
Bearing Outside Diameter, Nominal (Do)	32.000
Washer Inside Diameter, Nominal (di)	18
Washer Inside Diameter Tolerance (di tol.) - +0.25 / -0	+0.25 / 0
Washer Outside Diameter, Nominal (Do)	32
Washer Outside Diameter Tolerance (Do tol.) - +0 / -0.25	+0 / 0.25
Washer Thickness, Nominal (S3)	2
Washer Thickness Tolerance (S3 tol.) - +0 / -0.05	+0 / 0.05
Mounting Hole Dia. (dm)	2.000
Mounting Hole Pitch Dia. (dp)	25
Housing Counterbore Depth (Ha)	1.00
Housing Counterbore Depth Tolerance (Ha tol.) - +0.2 / -0.2	+0.2 / 0.2
Housing Counterbore Diameter, Nominal (HD)	32.000

AST11 WC18 Bearing 2D drawings and 3D CAD models



BEARING-SINGAPORE (PTE)LTD.

Housing Counterbore Diameter Tolerance (HD tol.)	+0.12 / 0
Material	Bronze shell with PTFE / Fiber lining