

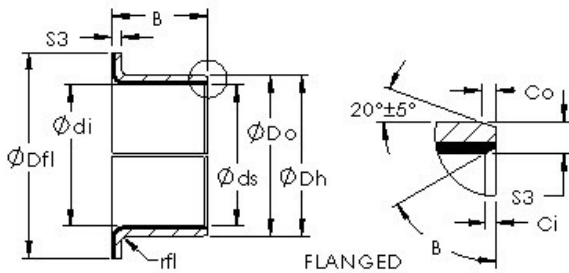

BEARING-SINGAPORE (PTE)LTD.



AST AST50 20FIB24 plain bearings

Bearing No. AST50 20FIB24

Bore Diameter	31,75 mm
Bearing Type	flanged
Shaft Dia., Nominal (d)	1.2500
Shaft Size (ds) - 1.2488	1.2472
Housing Bore Dia. (Dh) - 1.4068	1.4058
Bearing Bore after Mounting (di) - 1.2528	1.249
Average Clearance (Cd)	0.0029
Wall Thickness (S3)	0.079
Bearing Length, Nominal (B)	1.500
Bearing Length Tolerance (B tol.) - +.010 / -0.010	+0.010 / 0.010
OD Chamfer Length (Co)	0.045
ID Chamfer Angle (B deg.)	30
ID Chamfer Length (Ci)	0.020
Flange Dia. (Dfl pm 0.5)	1.750
Flange Thickness (Sfl)	0.078
Flange Radius (rfl)	0.060
Material	Carbon steel shell with PTFE / Fiber lining

AST50 20FIB24 Bearing 2D drawings and 3D CAD models